

# Secondary Glazing Horizontal and Vertical Slider Locks and Insulation Seal

Slide locks fit all outerframes

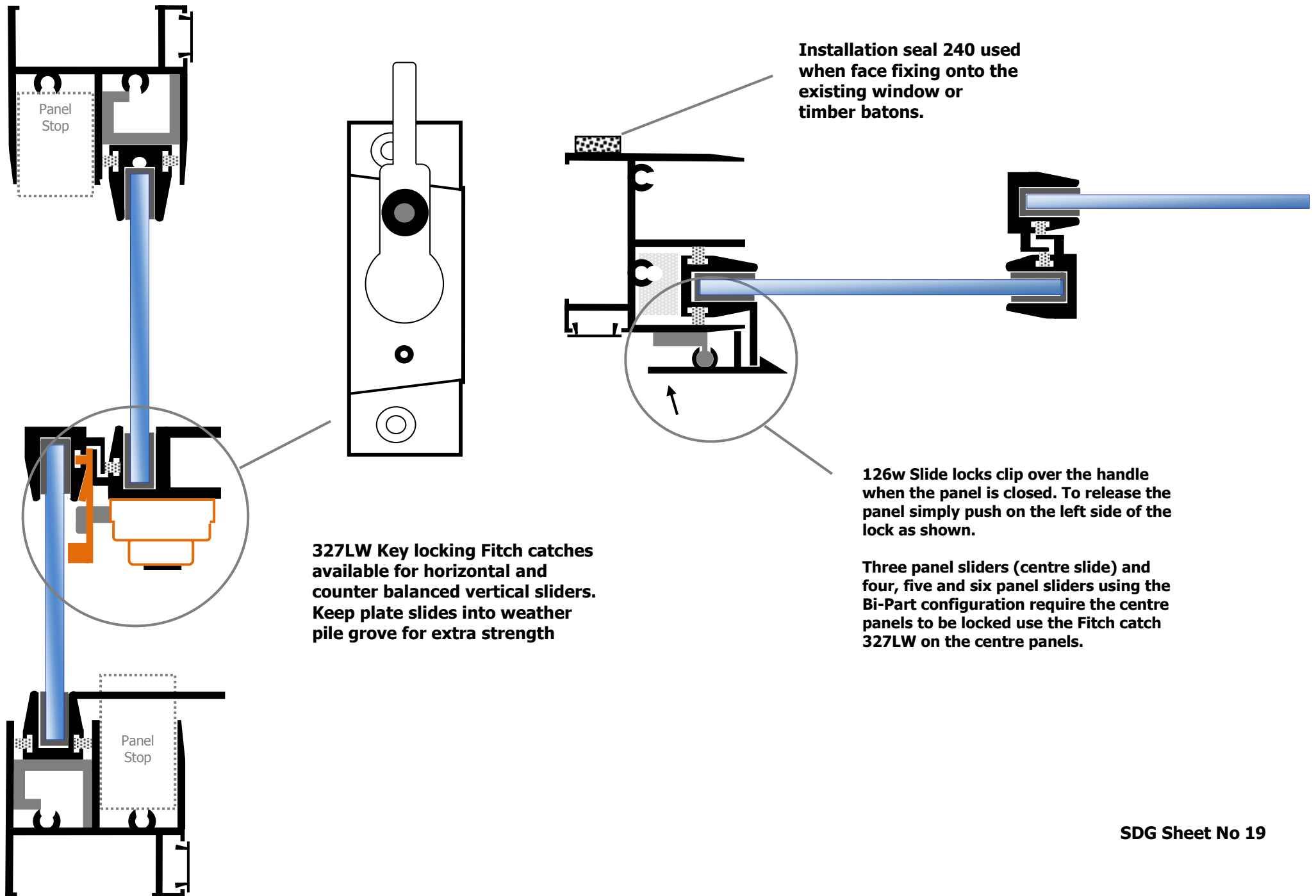

Installation seal 240 used when face fixing onto the existing window or timber batons.

**327LW Key locking Fitch catches available for horizontal and counter balanced vertical sliders. Keep plate slides into weather pile groove for extra strength**

**126w Slide locks clip over the handle when the panel is closed. To release the panel simply push on the left side of the lock as shown.**

**Three panel sliders (centre slide) and four, five and six panel sliders using the Bi-Part configuration require the centre panels to be locked use the Fitch catch 327LW on the centre panels.**